

STEP BY STEP GUIDE TO MAINTAINING YOUR MAGNAPOL

SEASON START:

At the start of the swimming season perform your regular start up procedures, such as checking water levels, checking all safety equipment around the pool area, cleaning baskets and skimmer boxes and taking a water sample to your local pool shop for a thorough analysis. You should also :

- A. Perform a backwash to clear out the filter of any lingering debris
- B. Check for the presence of phosphates and remove with Zodiac Phosphate Remover as soon as possible
- C. Check MagnaPool salinity levels are correct (between 4000-5000ppm). If low, check the guide on the back page and add accordingly. If higher than 5000ppm leave as is

REGULAR MAINTENANCE THROUGH THE SEASON

1. When having your water chemistry checked be sure to tell your pool shop that you have a MagnaPool (if necessary take this info sheet with you). There are certain readings that your pool shop will need to be aware of that are unique to a MagnaPool. See below for special note on water testing.
2. Ensure your mineral levels are correct at all times and add MagnaPool minerals as required. The add minerals light located on the power pack will let you know when you are getting low.
3. Visually check your cell every month in the swimming season. If you notice any deposits remove the cell and clean off with a diluted acid solution (see the Hydroxinator owners manual for instructions). And have the hardness level checked and corrected as per the outline below.



WATER TESTING SPECIAL INFORMATION

All water test parameters remain as per standard water testing and treatment of a saltwater pool. However, magnesium will cause the hardness reading to appear unusually high. It is imperative that at least once a year a true calcium hardness reading is conducted by your local pool care professional to ensure you have correct calcium balance in your pool.

If starting your MagnaPool pool from a new pool, your calcium levels should be around 50-150ppm for a fibreglass pool or 150-500ppm for a concrete pool.

If retrofitting to an existing pool, take a sample of water to a pool shop prior to adding MagnaPool and make any required adjustments, paying particular attention to the hardness levels to ensure correct levels.

GENERAL INFORMATION & TROUBLE SHOOTING GUIDE

THE MAGNAPOOL MINERALS IN THE BAGS HAVE CLUMPED TOGETHER INTO A SOLID BLOCK.

This usually indicates the minerals have been exposed to air and moisture. The minerals are still good to be used but will take longer to dissolve. Be sure to monitor and brush minerals around the pool as they dissolve.

THERE IS WHITE FROTH ON THE WATER SURFACE AFTER ADDING THE MINERALS.

This is normal during the start-up process as the minerals reach equilibrium with the water. It will dissipate usually within a few hours or sometimes overnight with the pump running.

AFTER ADDING MINERALS YOU NOTICE A YELLOWISH DISCOLOURATION ON THE POOL FLOOR.

This can be caused by a concentration of minerals that have settled on the bottom of your pool due to insufficient circulation after dosing the minerals. It is recommended to leave pumps running overnight to evenly distribute the minerals. If the discolouration remains try using Zodiacs 'All in one stain remover'.

I CANNOT DETECT CHLORINE IN MY POOL AFTER ADDING MINERALS.

Most testing equipment cannot detect chlorine levels accurately due to so much activity happening in the water during this process. Don't be alarmed, chlorine is present and effective, simply leave the Hydroxinator on boost mode overnight and you will find within a few days (can take up to a week in some pools) you will be able to detect the sanitiser levels. Even though sanitiser levels are not detectable, the water is safe to swim in



THERE IS WHITE RESIDUE OCCURRING AT THE WATERLINE OR IN THE POOL.

Check that the water chemistry is balanced paying particular attention to your pH and Hardness levels. As discussed magnesium will interfere with Total Hardness tests so be sure to follow the steps outlined above and ensure your mineral levels are correct and add as required.



Exceptional
Bather Comfort



Crystal Clear
Water



Environmental
Benefits



ARE THERE ANY PRODUCTS INCOMPATIBLE WITH MAGNAPOOL?

If granular chlorine is required at all, use Calcium Hypochlorite (Zodiac Pool Chlorine) instead of Dichloroisocyanurate (Zodiac Pool Purifier) as this can cause a discolouration to occur in the water.

WHY DO I HAVE TO ADD MORE BAGS OF MAGNAPOOL MINERALS COMPARED TO TRADITIONAL SALT?

Magnapool minerals are not chemically equivalent to traditional salt. The hygroscopic nature of Magnesium chloride means that when it is added to the pool it doesn't deliver the same level of salinity. Whereas salt delivers 1:1 ratio of salinity, magnesium delivers only 0.7:1, therefore more is required to deliver the same level of salinity.

USING THE MAGNAPOOL MAGNESIUM TEST STRIP

The magnesium test strip will help you monitor your magnesium mineral levels. Magnesium ions will increase over time as you add minerals. The test strip will help you check if magnesium levels are low and may need to be topped up to bring the water up to the 'comfort zone'. If the levels are high this is fine there is no need to do anything.

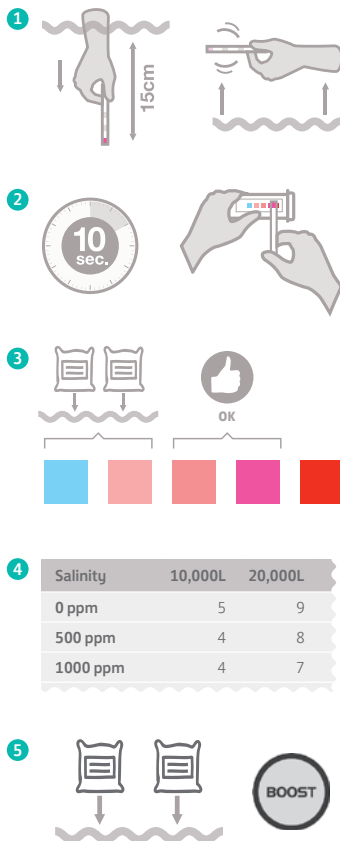

USE THE STRIP ACCORDING TO INSTRUCTIONS:

1. Take a sample of water and dip the test strip, shake of excess water
2. Wait 10 secs and compare colours
3. If below the 'OK' zone you will need to add minerals
4. Visit your local MagnaPool specialist pool shop and ask for a salinity test. Match up the salinity or TDS reading with your pool size by using the chart on the back of this brochure.
5. Add the prescribed bags of minerals to the MagnaPool and press boost on your hydroxinator (this will keep circulation operational for 24hrs)

WATER CHEMISTRY PARAMETERS

All measurements PPM*	Free Chlorine*	pH	Total Alkalinity*	Calcium Hardness* (see note below)	Cyanuric Acid*	Ideal Salinity Level*
Ideal For MagnaPool	1-3	7.2-7.6	80-120	300-1200	Less than 30	4,000-4,500
To Increase	Press Boost	Add Soda Ash (use pH UP)	Add Sodium Bicarbonate (use Alkalinity UP)	Add Calcium Chloride (use Calcium UP)	Add CYA (use UV Blockout)	Add MagnaPool Minerals
To Decrease	N/A	Add acid (use pH DOWN or Liquid Acid)	Add acid (use pH DOWN or Liquid Acid)	Partially drain/refill (or use Calcium Down)	Partially drain/refill	Partially drain/refill

NOTE FOR POOL SHOP: When testing total hardness in a mineral pool the readings will appear to be very high and it is vitally important for water balance that your 'calcium hardness' is correct. For an accurate test however, please use the hardness test kit or the magnesium spin disk. The test strip is a guide only. Please note: Total Hardness no less than 300 should be achieved.

MAINTAINING YOUR MAGNAPOOL MINERAL LEVELS

MAINTENANCE USING SALINITY AS YOUR MEASUREMENT

If your **current Salinity** measurement is as shown in the first column add the amount of MagnaPool Mineral bags according to your pool size. This will bring your MagnaPool Minerals up to the correct level.

Salinity	10,000L	20,000L	30,000L	40,000L	50,000L	60,000L	70,000L	80,000L	90,000L	100,000L
0 ppm	5	9	14	19	24	28	33	38	42	47
500 ppm	4	8	12	16	21	25	29	33	37	41
1000 ppm	4	7	11	14	18	21	25	28	32	35
1500 ppm	3	6	9	12	15	18	21	24	26	29
2000 ppm	2	5	7	9	12	14	16	19	21	24
2500 ppm	2	4	5	7	9	11	12	14	16	18
3000 ppm	1	2	4	5	6	7	8	9	11	12
3500 ppm	1	1	2	2	3	4	4	5	5	6
4000 ppm	0	0	0	1	1	2	2	2	3	3
4500 ppm	0	0	0	0	0	0	0	0	1	1

MAINTENANCE USING TDS AS YOUR MEASUREMENT

If your **current TDS** measurement is as shown in the first column add the amount of MagnaPool Mineral bags according to your pool size. This will bring your MagnaPool Minerals up to the correct level.

TDS	10,000L	20,000L	30,000L	40,000L	50,000L	60,000L	70,000L	80,000L	90,000L	100,000L
500 ppm	4	8	13	17	21	25	30	34	38	42
1000 ppm	4	8	11	15	19	23	26	30	34	38
1500 ppm	3	7	10	13	16	20	23	26	30	33
2000 ppm	3	6	8	11	14	17	20	23	25	28
2500 ppm	2	5	7	9	12	14	16	19	21	24
3000 ppm	2	4	6	8	9	11	13	15	17	19
3500 ppm	1	3	4	6	7	8	10	11	13	14
4000 ppm	1	2	3	4	5	6	7	8	8	9
4500 ppm	0	1	1	2	2	3	3	4	4	5

FOR MORE INFORMATION

If you are searching for more information, go to www.magnapool.com. Here you can find your closest MagnaPool specialist, more information on the product and ask us any questions or provide feedback on your MagnaPool experience.

